

PowerFlo II™

SP1700 PUMP SERIES REPLACEMENT PARTS

Pumps

Parts for Pump Models: SP1705, SP1710, SP1711, SP1720, SP1725, SP1750, SP1775, SP1780

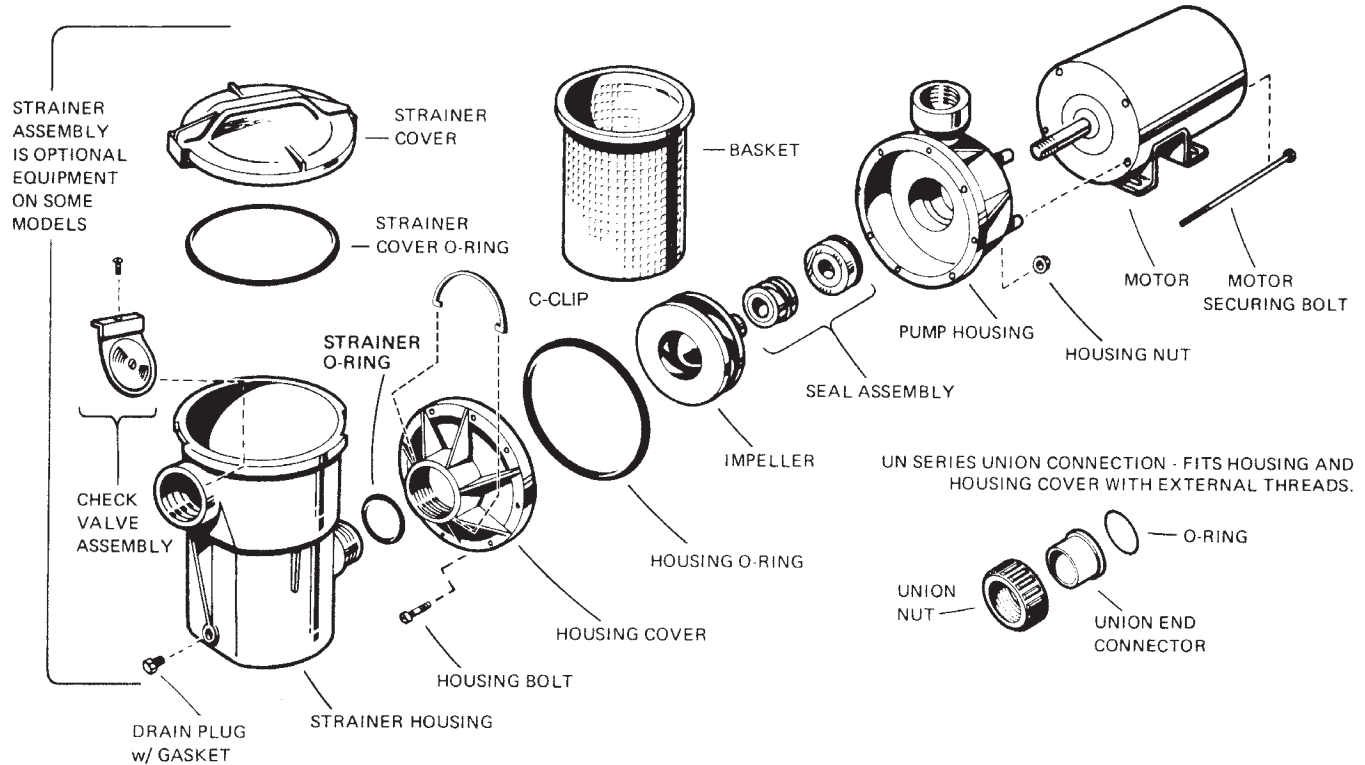

Part No.	Description	Ctn. Qty.
SPX1705AA	Pump Housing	1
SPX1705B	Housing Cover with Integral Diffuser (SP1700 Series, PowerFlo II)	20
SPX1500KA	Seal Assembly with Cup	10
SPX1720KA	Seal Assembly (PowerFlo II, 1 and 1 1/2 H.P.)	50
SPX1705Z1	Housing O-Ring Gasket	10
SPX1500N2	Housing Bolt, No. 10-24 Hex. Head	25
SPX1500Y2	Housing Nut, No. 10-24 Hex.	25
SPX1705C	Impeller, 1/2 H.P. (SP1700 Series, PowerFlo II)	10
SPX1707C	Impeller, 3/4 H.P. (SP1700 Series, PowerFlo II)	10
SPX1711C	Impeller, 1 H.P.	10
SPX2607C	Impeller (PowerFlo III, 1 H.P.)	10
SPX2610C	Impeller (PowerFlo III, 1 1/2 H.P.)	20
SPX1500CAP	Strainer Housing with Basket	1
SPX1500D2A	Strainer Cover with O-Ring	10
SPX1500P	Strainer Cover O-Ring	50
SPX1250RA	Strainer Basket	10
SPX1500LX	Strainer Basket – Large, 4 1/2" x 7" (1992)	10
SPX1500RA	Check Valve Assembly (1992 and Prior)	50
SPX1500W	Strainer O-Ring	50
SPX1700FG	Drain Plug with Gasket – SP1700 Series Housing	50
SPX1515C	Strainer Housing C-Clip (2000-2003)	50
SPX1515CN	Strainer Housing C-Clip (2004-)	10
SPX1500JS	Union End Connector – Socket	25
SPX1500JT	Union End Connector – Threaded	5
SPX1500G	Union Nut	10
SPX1495Z1	O-Ring, End Connector	50
SPXHKIT12	H-KIT Quick Pump Repair for PowerFlo (Includes SPX1500KA, SPX1580Z1, SPX1500P, SPX1500W, SPX1500H, SPX1705Z1 and Jack's Lube)	10

NOTE: Parts for PowerFlo Pump Motors are listed on page 169.